

Treehouse at Easthampton Meadow, Easthampton, MA

1 Treehouse Circle

6 acres

60 units (in 23 residential buildings)

Density: 10 units/acre; 2.6 buildings/acre

Treehouse at Easthampton Meadow offers 60 apartment homes, comprised of 48 one-bedroom cottages for people ages 55 and older, and 12 multi-bedroom townhouses for families. Of the 12 family townhomes, six are Affordable and six are rented at market rates. All of the one-bedroom apartments are Affordable (deed restricted). Treehouse is an intentional, intergenerational community that integrates family housing for households who have adopted children out of the foster system with households aged 55+ who agree to mentor the children.

[Planning & Programs - Success Stories - Treehouse at Easthampton Meadow \(masshousing.com\)](https://masshousing.com/planning-programs-success-stories/treehouse-at-easthampton-meadow)

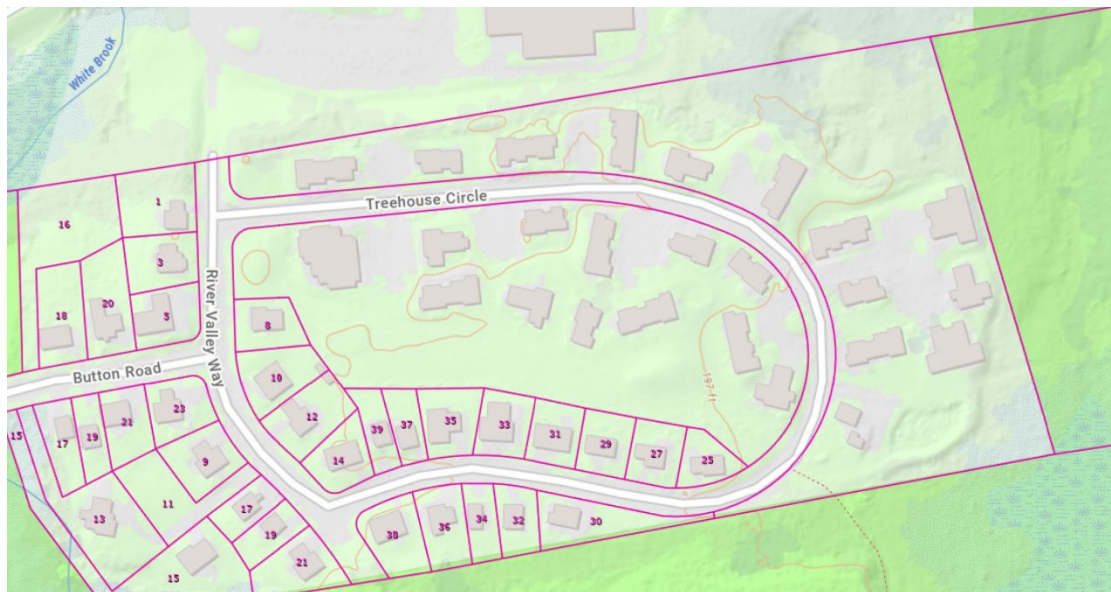



References:

<https://www.masshousing.com/en/programs-outreach/planning-programs/treehouse-easthampton>

<https://www.newecology.org/treehouse/>

<https://www.davissquarearchitects.com/projects/treehouse-at-easthampton-meadow>

Cherry Hill Cohousing, Amherst (formerly Pioneer Valley Cohousing)

22 acres total

32 units clustered on 6 acres:

- 8 detached single-family (8 units)

- 9 duplexes (18 units)

- 2 triplexes (6 units)

Homes are clustered on the site and oriented around a pedestrian walkway.

Density:

Housing density: 32 units/6 acres = 5.3 units/acre

Site density: 32 units/22 acres = 1.45 units/acre

16 acres open space = 72% of total site

Unit sizes: 616 to 1,600 square feet

Demographics (varies):

- Number of adults: 70

- Number of children: 15

- Number of renters: 20



References:

<https://web.cohousing.com/>

