

CHRISTINE J. WALTON  
BOOK 11833 PAGE 212  
PLAN BOOK 186 PAGE 77

PARCEL 2  
AREA=  
9,098± S.F.

S25°04'55"E 150.00'  
N25°04'55"W 150.00'

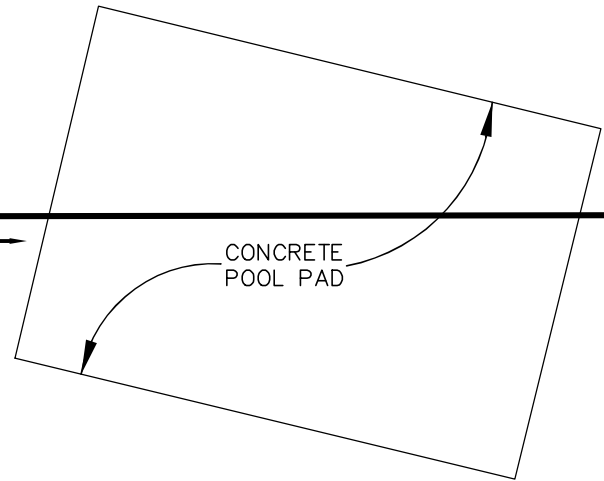

PARCEL 1  
AREA=  
29,324± S.F.

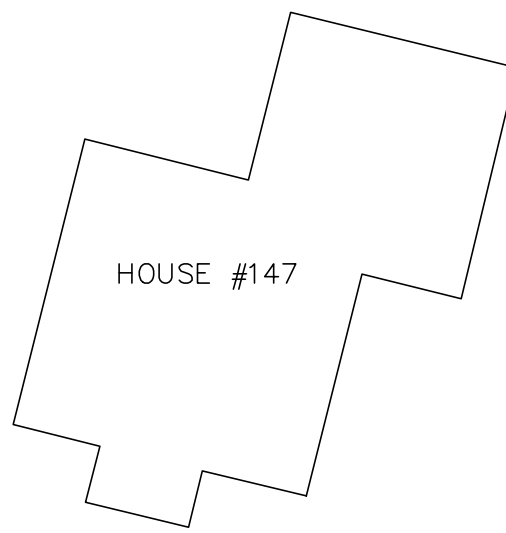

TIFFANIE C. WALTON &  
JEFFREY L. LEVREULT  
BOOK 10473 PAGE 342  
PLAN BOOK 88 PAGE 100

PAMELA J. TESSIER &  
KEVIN T. MICKNA  
BOOK 12103 PAGE 302

CHRISTINE J. WALTON  
BOOK 11833 PAGE 212  
PLAN BOOK 186 PAGE 77

TARA D. SUDYKA  
BOOK 12263 PAGE 114  
PLAN BOOK 82 PAGE 38  
LOT 3

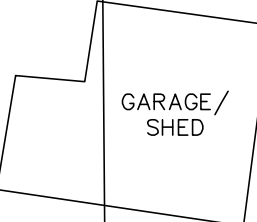

S78°54'01"W  
201.97'

201.25'  
N78°57'06"E

150.00'  
S25°21'54"E

OLD LYMAN ROAD  
PUBLIC

NOTE:

PARCEL 2 TO BE CONVEYED BY CHRISTINE J. WALTON TO TIFFANIE C. WALTON AND JEFFEREY L. LEVREULT AND COMBINED WITH PARCEL 1 TO FORM ONE CONTIGUOUS PARCEL OF LAND.

MINIMUM ZONING REQUIREMENTS				
DISTRICT	AREA (S.F.)	LOT FRONTAGE	SETBACK	
			FRONT	REAR
RA-1	22,500	125	40'	25'

PLANNING BOARD  
SOUTH HADLEY, MASSACHUSETTS

APPROVAL UNDER SUBDIVISION  
CONTROL LAW NOT REQUIRED

DATE \_\_\_\_\_

\_\_\_\_\_  
\_\_\_\_\_  
\_\_\_\_\_  
\_\_\_\_\_

REGISTRY OF DEEDS  
HAMPSHIRE COUNTY

SUBDIVISION APPROVAL NOT REQUIRED PLAN OF LAND IN  
**SOUTH HADLEY, MASSACHUSETTS**  
SURVEYED FOR  
**TIFFANIE C. WALTON & JEFFERY L. LEVREULT**

SCALE: 1" = 20'

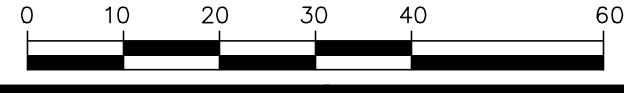

DATE: DECEMBER 3, 2019

**HERITAGE SURVEYS, INC.**  
REGISTERED PROFESSIONAL LAND SURVEYORS  
COLLEGE HIGHWAY & CLARK STREET  
POST OFFICE BOX 1  
SOUTHAMPTON, MASSACHUSETTS  
(413) 527-3600

LEGEND	
BOUND FOUND	□
IRON PIPE FOUND	○
IRON ROD FOUND	●
IRON PIPE TO BE SET	●

THIS SURVEY AND PLAN WERE PREPARED IN ACCORDANCE WITH THE RULES AND REGULATIONS OF THE REGISTERS OF DEEDS, AND THE PROCEDURAL AND TECHNICAL STANDARDS FOR THE PRACTICE OF LAND SURVEYING IN THE COMMONWEALTH OF MASSACHUSETTS.

12/3/19  
DATE REGISTERED LAND SURVEYOR \_\_\_\_\_